

the URBAN MEADOW

MIDTOWN • HARRISBURG

The Urban Meadow is the primary pedestrian connection between the HACC Community Center for Technology and Art (on 4th Street) and the expanded HACC facilities at the recently renovated Evangelical Press Building (on 3rd Street) one block to the west. The Urban Meadow is a contemporary piece of urban design that addresses the core issues of public life in an ever-changing urban context while respecting the traditional needs and values of an existing community. Natural, indigenous elements from the Susquehanna River Valley are combined with new and recycled materials that are reinterpreted to create a unique, environmentally sensitive, and sculptural public open space.

Native trees such as River Birch are used to create a central allee, Sassafras and Serviceberry trees are planted in small groves that wrap and shelter open areas of lawn and granite seating created from salvaged granite slabs that were used historically as street curbs. A curvilinear series of sculptural earthworks are covered with ephemeral meadow grasses to create the unique and boldly sculptural quality of the Urban Meadow and distinguishes this area as a piece of nature "cut into a sea of asphalt parking." In an effort to reduce the negative impacts on the Susquehanna River ecosystem caused by the overflow of the combined sanitary and storm sewer system during rain events, storm water flowing off of the surrounding parking lots is collected in existing low areas where it is cleaned and treated by specialized flowering meadow plantings. New paving materials on Boyd Street and on axial pathways that connect to adjacent parking lots create a functional, comfortable and attractive pedestrian scale feel to the overall design. An innovative lighting design creates a safe, enjoyable and engaging nighttime environment allowing this space to function safely during the daytime and nighttime.

The Urban Meadow is a contemporary approach to providing public open space that is uniquely "Harrisburg." This small yet important public amenity helps to unite a historic mixed use neighborhood, a growing college community and a reinvigorating commercial, business, and entertainment faction of the Midtown area by providing a centralized common ground for public enjoyment and participation.

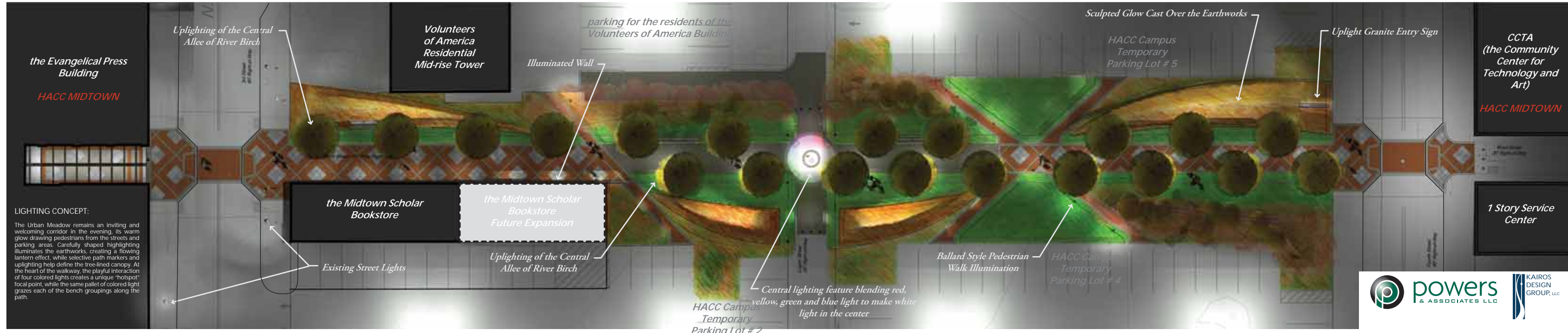
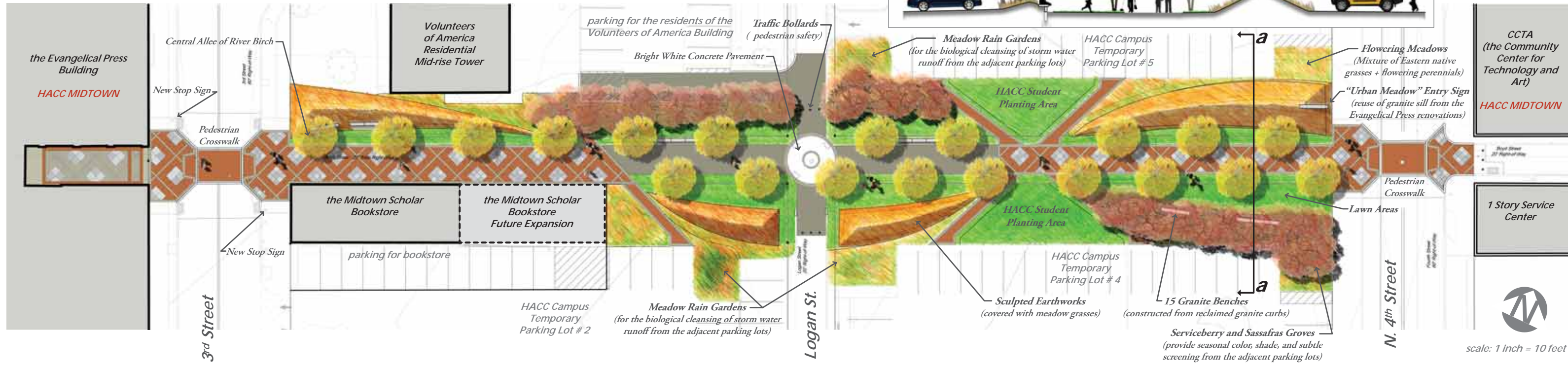

LIGHTING CONCEPT:
The Urban Meadow remains an inviting and welcoming corridor in the evening. Its warm glow drawing pedestrians from the streets and parking areas. Carefully shaped highlighting illuminates the earthworks, creating a flowing lantern effect, while selective path markers and uplighting help define the tree-lined canopy. At the heart of the walkway, the playful interaction of four colored lights creates a unique "hotspot" focal point, while the same pallet of colored light grazes each of the bench groupings along the path.